

Common supply manifold PAL-1/8-4

Part number: 8603

FESTO

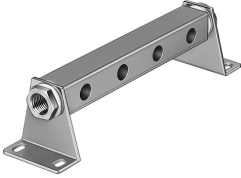

Data sheet

Feature	Value
Type code	PAL
Mounting position	Any
Max. no. of valve positions	4
Product weight	190 g
Type of mounting	With mounting bracket
Pneumatic connection 1	G1/4
Note on materials	RoHS-compliant
Material of sub-base	Aluminum Anodized